

24

SCHEME PLAN OF EXISTING LAND KHASRA NO. 316,317

AT VILLAGE DHATARWALO KA BAS TEHASIL- CHIDAVA, DIST- JHUNJHUNU, RAJASTHAN. BELONGS TO MR. G.SRINIVAS REDDY s/o SRI RAMA MOHAN REDDY 48-228, SURYA NAGAR, NEAR IDPL BUS STOP, HYDERABAD - 500032

SCALE :- 1" = 50'-0"

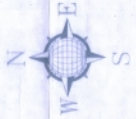
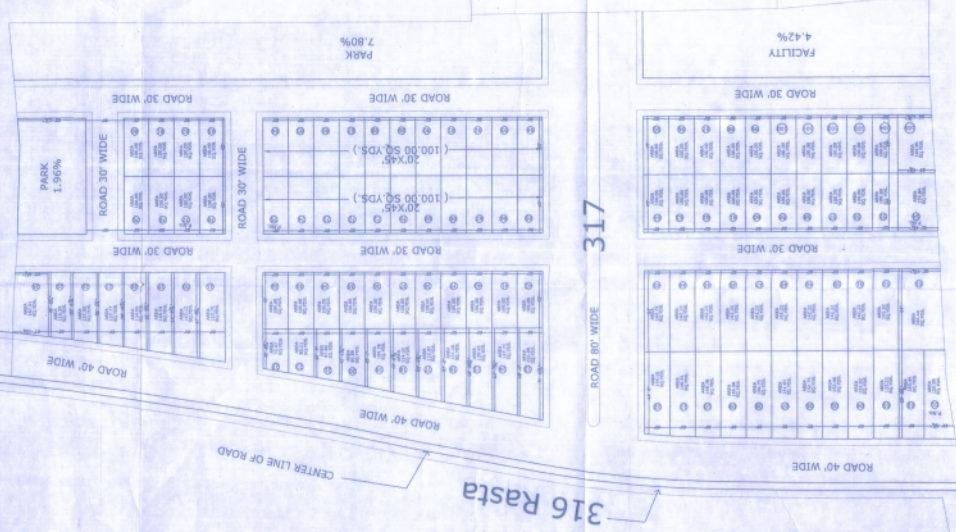
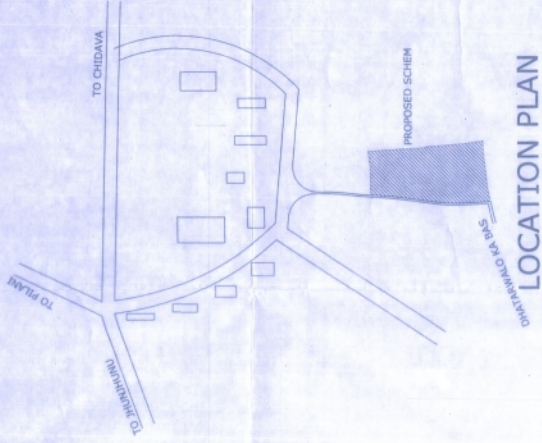

KHASRA NO. 316 = 0.21 Hector (Aam rasta)
KHASRA NO. 317 = 2.27 Hector
TOTAL LAND = 2.48 Hector

AREA STATEMENT :-

PARTICULARS	SQ. FEET	SQ. YARDS	SQ. METERS	HECTOR	PERCENTAGE
TOTAL SCHEME AREA	266933.008	29659.223	24807.900	2.27+0.21=2.48	100.00%
TOTAL RESIDENTIAL AREA	91307.381	10146.264	8485.816	0.85	34.20%
TOTAL ROAD AREA	139131.054	15459.006	12930.395	1.29	52.12%
TOTAL FACILITY AREA	12620.294	1402.254	1172.889	0.11	4.42%
TOTAL PARK AREA	23874.279	2652.697	2218.779	0.22	9.26%
TOTAL NO. OF PLOT	105				
TOTAL ROAD WIDTH	30'-0" / 80'-0"				

(Handwritten signatures and stamps)
 Prepared by: *(Signature)*
 Checked by: *(Signature)*
 Date: *(Date)*
 Scale: 1" = 50'-0"